



Flush Bolts

General hardware



Designed to fit flush when installed to the face or edge of the door the Legge Flush Bolts are a simple and effective method of securing the inactive leaf on a double leaf doorset.

Brass construction and four sizes means the Legge range of flush bolts meet any demand.

Features

- 25mm throw
- 12mm diameter bolt
- Visible fixing
- Supplied with screws
- Suitable for timber doors only

Warranties	
Mechanical	10 years
Finish	allegion.co.nz/finisheswarranty

Specification guide

Model	Size	Finish
Flush bolt DAX1901	150mm -01	Satin chrome plate..... SCP
Dust socketDAX1913	200mm -02	
Necked socket bolt LG12NSB	300mm -03	
	400mm -04	
	600mm -05	
	900mm -06	

1. Model
Select the desired model e.g. Flush bolt DAX1901
2. Size
Select the desired size e.g. 150mm DAX1901-01
3. Finish
Select the desired finish e.g. Polished brass DAX1901-01SCP

Finish



SCP

Satin Chrome
Plate

Specifications

Door type	Timber
Door thickness	32mm minimum
Material	Brass
Size	19mm wide, various lengths
Bolt	12mm diameter x 25mm throw

1912, 40012, 60012 & 80012 Flushbolt

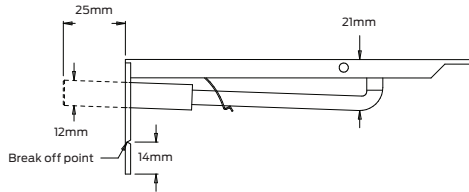
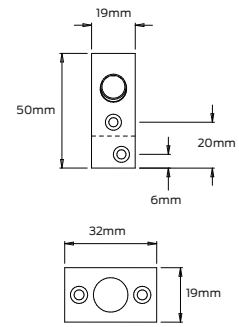
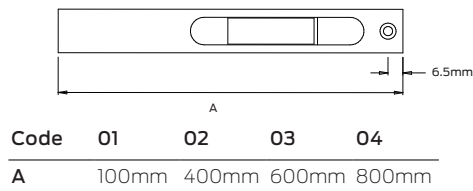

Flush bolt accessories

1913 Dust Socket

12mm shoot to suit 1901
Finish: Satin chrome plate

